



IMPORTANT REMINDER:

Reinstalling a Syringe

If you remove a syringe from the injector and then wish to reinstall it, perform the following steps:

1. Insert the end of the syringe in the horizontal cutouts in the injector head.

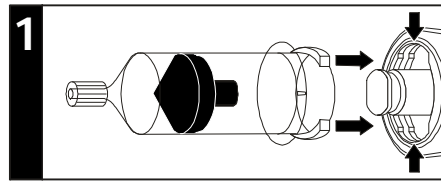

2. Advance the piston until it is past the plunger feet and the piston and plunger interlock.

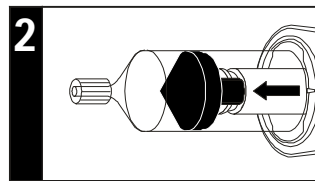

3. Rotate the syringe 1/4 turn clockwise until the syringe locks and alignment marks are positioned.

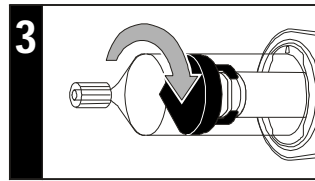

4. **CAUTION:** If plunger feet are not interlocked with the piston, as illustrated in Figure 4, damage to syringe may occur.

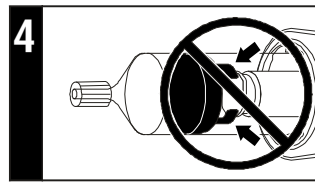

5. Proceed as normal by aspirating and dislodging any air bubbles.

This syringe is indicated for single use only with **Medrad** injectors. Please refer to the information that is included with your syringes for instructions, warnings/cautions, and contraindications.

MEDRAD[®]

www.medrad.com

Medrad, Inc.
One Medrad Drive
Indianola, PA 15051-0780
USA

Medrad Europe B.V.
Postbus 205
6190 AE Beek
The Netherlands

Nihon Medrad K.K.
Central Shin-Osaka
Building, 9F
4-5-36 Miyahara
Yodogawa-ku
Osaka, 532-0003
JAPAN

